

View 34: Representative Viewpoint 1 Tower Green, Inner Ward (new selected viewpoint) - Future Baseline

ED-HTB23

Future baseline

6.276 55 Gracechurch Street is seen stepping down from 20 Fenchurch Street. 50 Fenchurch Street and One Undershaft are either side of 22 Bishopsgate.



View 34: Representative Viewpoint 1 Tower Green, Inner Ward (new selected viewpoint) - Proposed Clusters

Proposed

6.277 The Proposed Cluster, shown in purple, would be seen extending to the east and west from this viewpoint. To the west it connects to 20 Fenchurch Street (not seen in this view) and to the east, the form steps down to create a defined edge with clear sky space around. In addition to the future baseline, the Cluster would have more of a quantitative effect which would be **neutral**. Proposals for new tall buildings on relevant sites within the Proposed City Cluster would need to be carefully scaled and designed to respond to the sensitivity of this foreground.



View 35: Representative Viewpoint 1 Tower Green, Inner Ward (new selected viewpoint) - Existing

Existing

6.278 This view is taken from the Inner Ward, outside the White Tower, further south from view 26 looking towards the City. In the foreground, several buildings within the Tower appear, including Beauchamp Tower, the Chaplain's House, the Chapel Royal of St Peter ad Vincula and Waterloo Barracks. Tower Green and the former scaffold site also appear in the foreground. The Cluster appears in the background, behind the Chapel and its bell tower.



View 35: Representative Viewpoint 1 Tower Green, Inner Ward (new selected viewpoint) - Future Baseline

Future baseline

6.279 50 Fenchurch Street, One Undershaft, and 100 Leadenhall Street are visible, adding to the existing City Cluster.





View 35: Representative Viewpoint 1 Tower Green, Inner Ward (new selected viewpoint) - Proposed Clusters

Proposed

6.280 The Proposed Cluster, shown in purple, would be seen extend to the east and west from this viewpoint. To the west it connects to 20 Fenchurch Street (not seen in this view) and to the east, the form steps down to create a defined edge with clear sky space around. In addition to the future baseline, the Cluster would have more of a quantitative effect which would be **neutral**. Proposals for new tall buildings on relevant sites within the Proposed City Cluster would need to be carefully scaled and designed to respond to the sensitivity of this foreground.



View 36: Representative Viewpoint 1 Tower Green, Inner Ward (new selected viewpoint) - Existing

Existing

6.281 This view is taken from the Inner Ward, outside the White Tower, looking west with the City to the right. The middle ground is formed by the buildings within the ToL, including Beauchamp Tower, the Chaplain's House, the Chapel Royal of St Peter ad Vincula and Waterloo Barracks. Tower Green and the former scaffold site appear in the foreground. The City Cluster appears in the background, behind the Chapel; 20 Fenchurch Street is seen behind the bell tower of the Chapel. The lantern of the Old London Port Authority building is seen to the right in the foreground of the City Cluster.





View 36: Representative Viewpoint 1 Tower Green, Inner Ward (new selected viewpoint) - Future Baseline

Future baseline

6.282 70 and 85 Gracechurch Street are glimpsed to the right of the bell tower. Further right the larger proposals of 50 Fenchurch Street, One Undershaft and 100 Leadenhall Street are visible.



View 36: Representative Viewpoint 1 Tower Green, Inner Ward (new selected viewpoint) - Proposed Clusters

Proposed

6.283 The three crests of the Proposed City Cluster are appreciable in this view, stepping down to the south. This is an increased backdrop to the Chapel Royal of St Peter ad Vincula. In addition to the future baseline, the Cluster would have more of a quantitative effect which would be **neutral** overall. Proposals for new tall buildings on relevant sites within the Proposed City Cluster would need to be carefully scaled and designed to respond to the sensitivity of this foreground.



View 37: Representative Viewpoint 2 Inner Curtain Wall North (new viewpoint -panned west) - Existing

Existing

6.284 This view is taken from the Inner Curtain Wall, on the north side of the ToL, which is not publicly accessible. It looks away from the ToL, towards the City.

6.285 The Tower of London Setting Study gives the following description of the view: *'Looking north, the view is composed of the buildings to the north of the Inner Curtain Wall. The Casemates, which are the chambers in the Outer Curtain Wall built as military stores in the 19th century and which now house Yeoman Warders, form the foreground of the view. An area of open space with mature trees, and the A100 (Tower Hill), both sit to the north of the Outer Curtain Wall and form the middle ground of the view. Buildings of the City, including Swiss Re, form the background of the view, which is framed on either side by the Martin and Brick Towers. The buildings of the city break the clear skyline of the Brick Tower at its edge.'*

6.286 The Old London Port Authority building appears in the middle of the view, behind Trinity Square Gardens, and the existing City Cluster appears behind it, to the right with 20 Fenchurch Street at a distance to the left.

6.287 The Tower of London Setting Study gives the following description of the significance of this view: *'Views from this area exemplify many of the cultural qualities that give the Tower its OUV, including its landmark siting (as demonstrated by the position of the Tower in relation to the City), views of the concentric castle design, visibility of the Inner and Outer Curtain Walls, the Martin and Brick Towers. The living tradition of the Tower, its rich ceremonial life, is represented in this view by the Casemates (home to the Yeoman Warders). Views across the Liberties of the Tower, north of the WHS, also reflect the military heritage.'*



View 37: Representative Viewpoint 2 Inner Curtain Wall North (new viewpoint -panned west) - Future Baseline

Future baseline

6.288 55 and 70 Gracechurch Street are seen either side of 20 Fenchurch Street. 50 Fenchurch fills the gap between 20 Fenchurch Street and the group to the north-east, and 85 Gracechurch Street is seen just behind. To the right of 22 Bishopsgate, One Undershaft and 100 Leadenhall Street add height to the eastern side of the City Cluster.

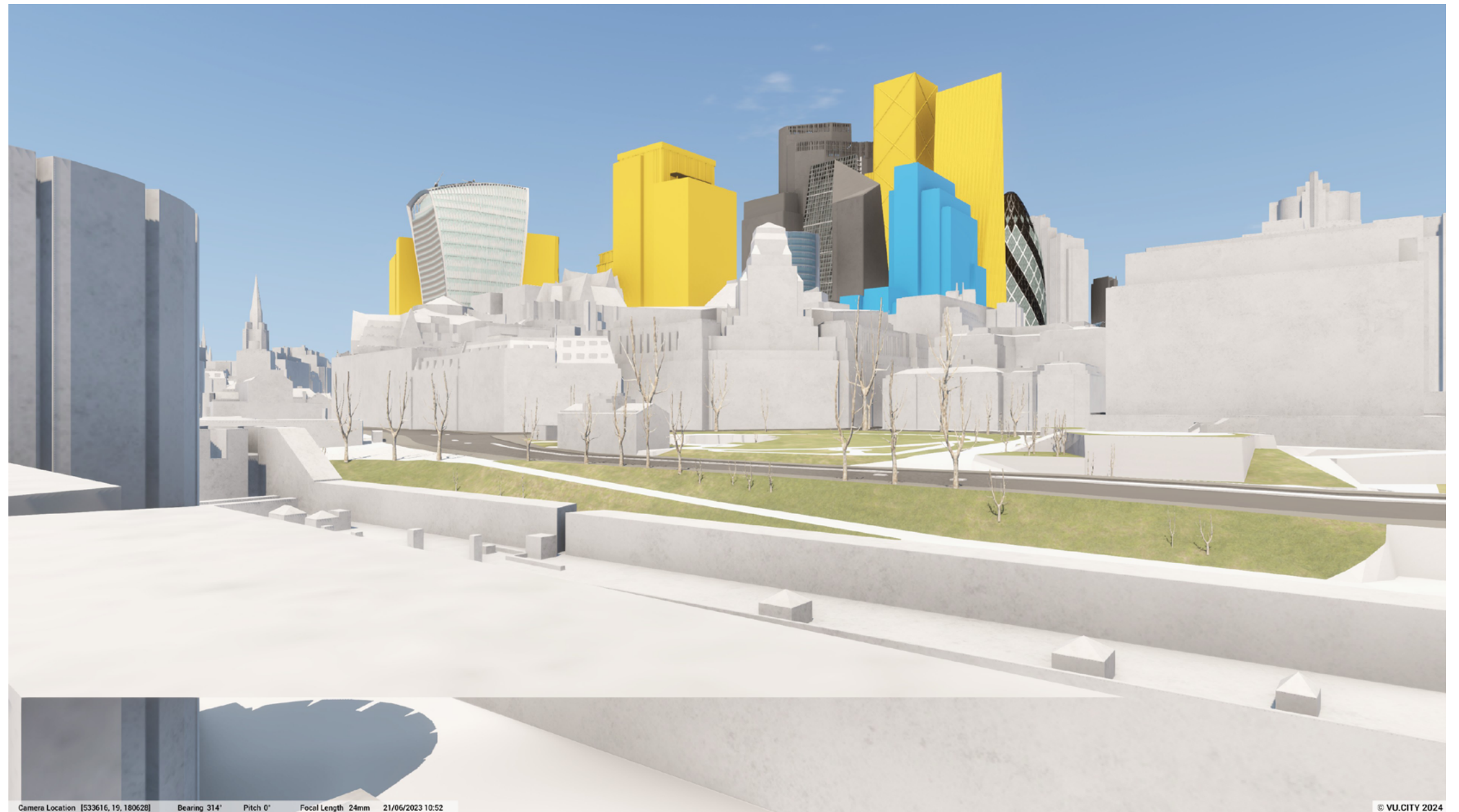



View 37: Representative Viewpoint 2 Inner Curtain Wall North (new viewpoint -panned west) - Proposed Clusters

Proposed

6.289 The full extent of the Proposed City Cluster, and its three crests, would be appreciable in this view. The low foothills to the south and east would provide important distance and breathing space between the WHS and the Proposed City Cluster's higher reaches at the intermediate crests at 20 and 50 Fenchurch Street and the northern apex at One Undershaft; it would appear as a dynamic, cascading form of modern architecture, with its tallest heights reached at its furthest point from the WHS. In this view, the effect would be **beneficial** through its consolidation of form behind lower foothills to the south and east.

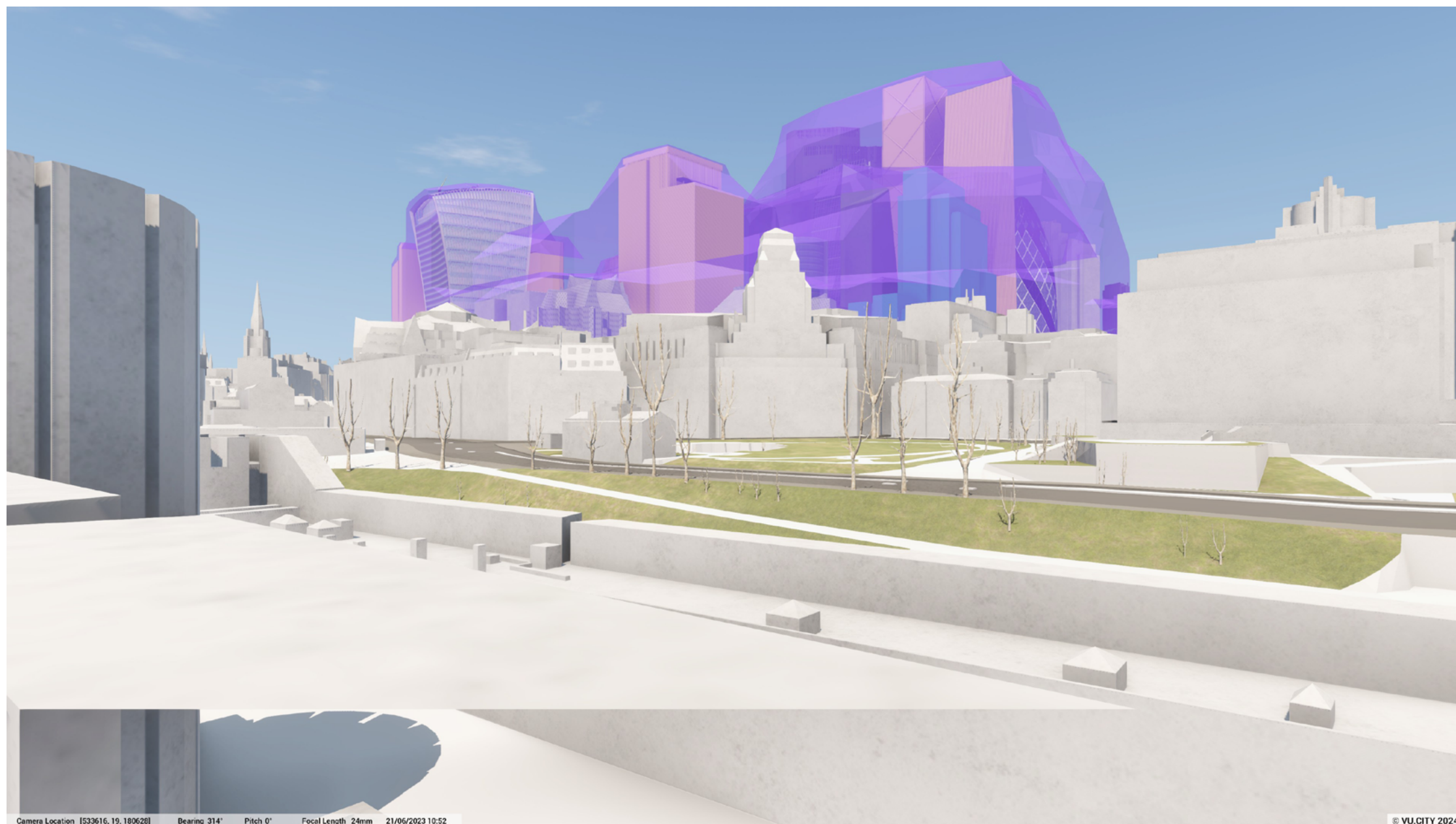

View 38: Representative Viewpoint 2 Inner Curtain Wall North - Existing

Existing

6.290 This view is taken from the Inner Curtain Wall, and looks west away from the Tower towards the City. The foreground includes buildings within the Tower, such as Casemates and Devereux Tower. The Old London Port Authority building is on the right, in the middle ground, and the City Cluster appears behind it. The spire of All Hallows by the Tower also appears in the middle ground. They appear beyond the trees and green along Tower Hill and within Trinity Square Gardens.





View 38: Representative Viewpoint 2 Inner Curtain Wall North - Future Baseline

Future baseline

6.291 55 and 70 Gracechurch Street are seen either side of 20 Fenchurch Street. 50 Fenchurch fills the gap between 20 Fenchurch Street and the group to the north-east, and 85 Gracechurch Street is seen just behind. To the right of 22 Bishopsgate, One Undershaft, and 100 Leadenhall Street add height to the eastern side of the City Cluster.



View 38: Representative Viewpoint 2 Inner Curtain Wall North - Proposed Clusters

Proposed

6.292 The full extent of the Proposed City Cluster, and its three crests, would be appreciable in this view. The low foothills to the south and east would provide important distance and breathing space between the WHS and the Proposed City Cluster's higher reaches at the intermediate crests at 20 and 50 Fenchurch Street and the northern apex at One Undershaft; it would appear as a dynamic, cascading form of modern architecture, with its tallest heights reached at its furthest point from the WHS. In this view, the effect would be **beneficial** through its consolidation of form behind lower foothills to the south and east.



View 39: Representative Viewpoint 2 Tower Green, Inner Ward (new viewpoint -panned east) - Existing

Existing

6.293 This view is taken from the north-east edge of the Inner Curtain Wall, looking away from the ToL. In the foreground are the Casements and beyond them are the trees and green along Tower Hill. 40 Trinity Square appears in the middle ground, on the left side of the view. One America Square appears in the background, and part of the existing City Cluster appear to its left, including 30 St Mary's Axe.



View 39: Representative Viewpoint 2 Tower Green, Inner Ward (new viewpoint -panned east) - Future Baseline

Future baseline

6.294 100 Leadenhall Street and One Undershaft step up to the left of 30 St Mary's Axe.





View 39: Representative Viewpoint 2 Tower Green, Inner Ward (new viewpoint -panned east) - Proposed Clusters

Proposed

6.295 The eastern edge of the Proposed City Cluster would be visible behind 40 Trinity Square in the foreground. The form of this edge would step down towards Tower Hill and Minories. This proposed consolidation would have a **beneficial** effect on the City Cluster form, and a **neutral** effect on the view overall. New tall buildings creating this eastern edge would need to be very carefully considered through detailed assessment of their architecture and urban design.



View 40: Representative Viewpoint 4 Inner Curtain Wall South (new viewpoint -panned west West) - Existing

6.296 This view is taken from the south end of the Inner Curtain Wall. It looks towards the City, and the existing City Cluster appears in the background. The view looks over the Inner Ward and the White Tower appears in the foreground on the right.

6.297 Buildings within the ToL appear in the middle ground, and are described in the Tower of London Setting Study as follows: *'characterised by the buildings which make up the Inner Ward, including [...] Waterloo Barracks behind the White Tower and the Chapel Royal of St Peter ad Vincula in the north-west corner.'*

6.298 The significance of this view is described in the Tower of London Setting Study: *'This view exemplifies many of the cultural qualities that give the Tower its OUV, including its role as a riverside gateway to the city, the concentric castle design, as a symbol of Norman power, the setting for key historical events and as an arsenal and prison.'*



View 40: Representative Viewpoint 4 Inner Curtain Wall South (new viewpoint -panned west West) - Future Baseline

Future baseline

6.299 55 and 70 Gracechurch Street would be seen either side of 20 Fenchurch Street, though largely obscured by trees. 85 Gracechurch Street, One Leadenhall Street and 50 Fenchurch Street step up to 22 Bishopsgate. One Undershaft and 100 Leadenhall Street step up further to the right.

